

MUEHLEBACH TOWER

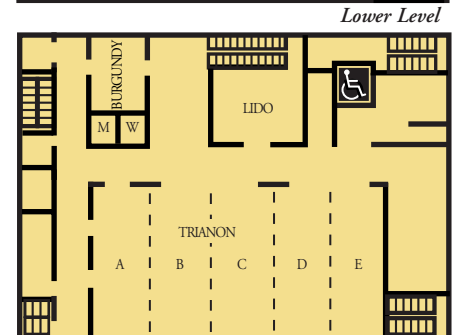
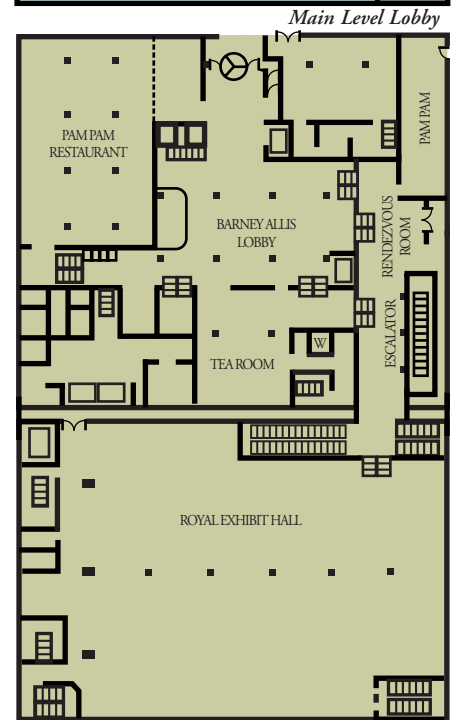
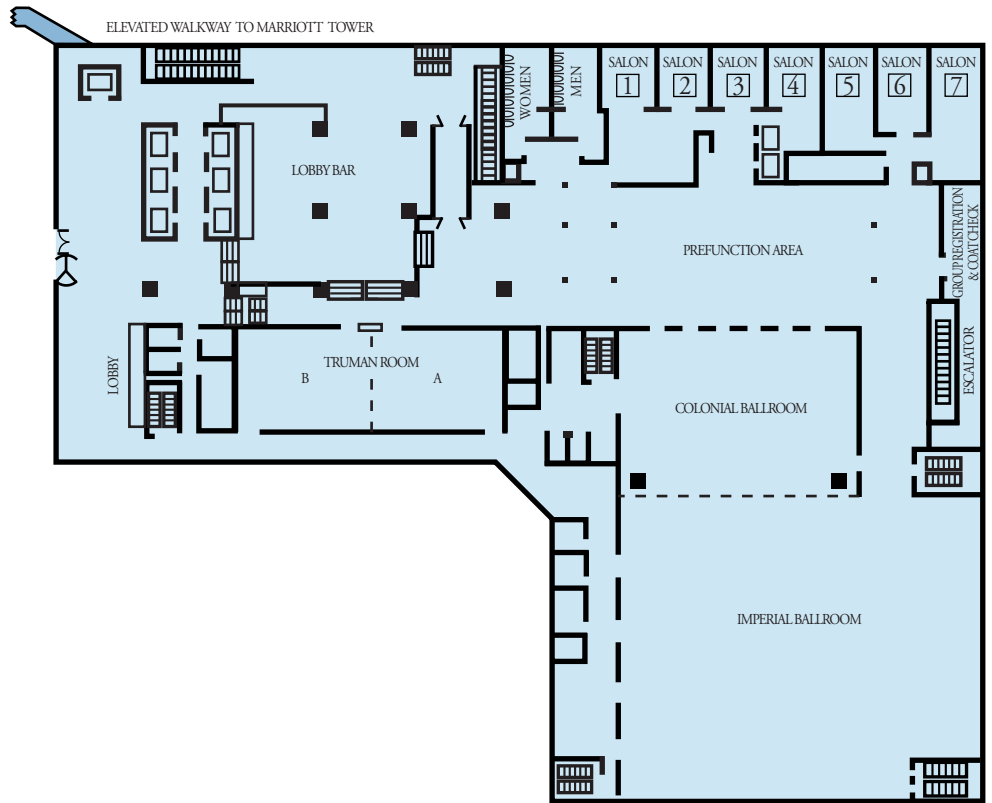
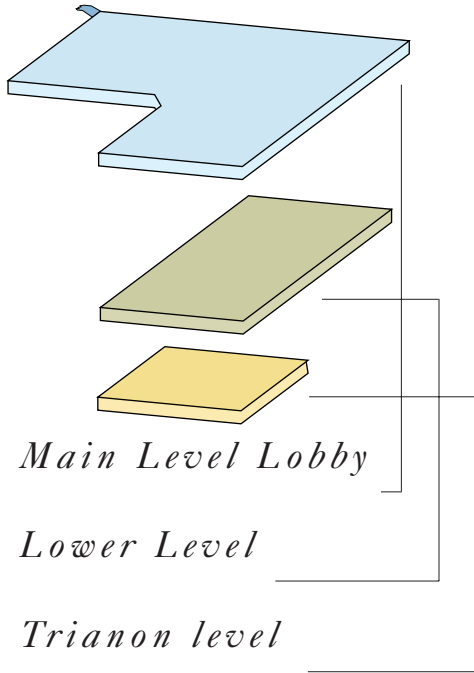

Ballroom & Meeting Room Setup Capacities		Width x Length	Ceiling Height	Square Feet	Banquet	Reception	School Room	Theater Seating	Exhibits 8' x 10'	U-Shape	Conference
Main Level Lobby	Imperial/Colonial	150 x 120	18'	17,040	1,400	2,400	1,050	2,200	95	---	---
	Colonial Ballroom	80 x 42	18'	3,360	240	400	200	300	17	---	---
	Imperial Ballroom	114 x 120	18'	13,680	1,170	1,750	900	1,700	78	---	---
	Truman Room A/B	36 x 84	10'	3,024	180	200	130	200	---	60	65
	Truman Room A	36 x 42	10'	1,512	90	150	70	100	---	30	30
	Truman Room B	36 x 42	10'	1,512	90	150	70	100	---	30	30
	Salon 1 Kennedy	17 x 22	8'	374	---	---	---	---	---	---	14
	Salon 2 Taft	17 x 28	8'	476	20	50	---	40	---	15	18
	Salon 3 Wilson	17 x 22	8'	374	20	50	18	40	---	---	14
	Salon 4 Hoover	17 x 28	8'	476	30	50	---	40	---	15	18
	Salon 5 Nixon	17 x 35	8'	595	30	50	18	40	---	15	14
	Salon 6 Eisenhower	17 x 28	8'	476	20	50	---	40	---	---	18
	Salon 7 Roosevelt	17 x 43	8'	731	40	50	30	60	---	33	36
Prefunction Area	50 x 144	7'	7,200	---	800	---	---	---	---	---	
Lower Level	Royal Exhibit Hall	96 x 125	9'	12,000	600	1,000	400	800	75	---	---
	Tea Room	33 x 40	9'	1,320	50	100	50	100	---	25	35
	Barney Allis Lobby	48 x 64	15'	3,072	150	485	---	---	---	---	---
	Rendezvous	57 x 33	9'	1,881	40	100	---	---	---	---	---
Trianon Level	Trianon A/B/C/D	80 x 46	10'	3,680	270	400	250	300	50	---	---
	Trianon A	20 x 46	10'	920	70	100	55	70	10	52	58
	Trianon B	20 x 46	10'	920	70	100	55	70	10	52	58
	Trianon C	20 x 46	10'	920	70	100	55	70	10	52	58
	Trianon D	20 x 46	10'	920	70	100	55	70	10	52	58
	Trianon E	30 x 38	10'	1,140	60	55	50	70	8	35	50
	Burgundy	21 x 22	11'	462	30	45	30	40	---	15	18
	Lido	28 x 33	11'	924	70	90	50	80	---	33	42

Trianon Level